

PRODUCTION RELEASE & REVISION						
REV	DESCRIPT'N/BUYER	DWG No	PARTS No.	BY	CHK	DATE
A	INITIAL / NO BRAND	-----	50301994	S.A.PARK	N.C.PARK	10-05-M5

POLE MOUNT BRACKET INSTALLATION

- Attach the pole mount to the pole by inserting the (M8x100L) bolts between the two halves of the pole mount as illustrated in the figure. Secure the pole mount halves together using the nut (M8) and spring washer (M8). The pole mount must be attached to a structure or suitable material capable of supporting the final mount assembly.

Align the (wall) mount bracket holes to the pole mount plate holes and secure the bracket using the machine screws (M6x20L or M6x14L).

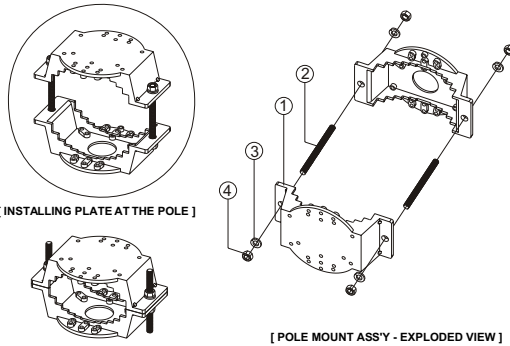

PART LIST

NO	PART NAME	Q'TY	DESCRIPTION
1	POLE MOUNT PLATE	2	Aluminum, light gray polyester powder coat
2	BOLT	2	M8x100L
3	HEX NUT	4	M8 type
4	SPRING WASHER	4	M8 type
5	MACHINE SCREW	4	PH M6x14L
6	MACHINE SCREW	8	PH M6X20L

Instruction Manual

PRINTED IN KOREA
50301994A

210(+/-3)mm

148(+/-3)mm

NOTES

- MODEL: **HCM151 / All Brand**
- MATERIAL: 일반인쇄용지 (WHITE)
BIND : -----
- FINISH: -----
- COLOR: TEXT-BLACK
- SIZE: 148(+/-5)mm x 210(+/-5)mm R: 0.0
- ANY CHANGE OR ALTERNATION MUST BE APPROVED BY HITRON ENGINEERING.

도급품 50301994

ITEM	DESCRIPTION/MATERIAL	QTY
PARTS LIST		
HITRON		
TITLE MANUAL INSTRUCTION		
MATERIAL	2	CHKED
FINISH	3	DRAWN
APPROVALS		DATE
N.C.PARK		10-05-M5
S.A.PARK		10-05-M5
SIZE	A4	DWG No
REV.	A	SCALE
P/N		DO NOT SCALE

의견	전자	안전규격	기구설계	영업
			김영관 김학인	천상현 김민원
			09/30/M5	10/05/M5

POLE MOUNT BRACKET INSTALLATION

- Attach the pole mount to the pole by inserting the (M8x100L) bolts between the two halves of the pole mount as illustrated in the figure. Secure the pole mount halves together using the nut (M8) and spring washer (M8). The pole mount must be attached to a structure or suitable material capable of supporting the final mount assembly.

Align the (wall) mount bracket holes to the pole mount plate holes and secure the bracket using the machine screws (M6x20L or M6x14L).

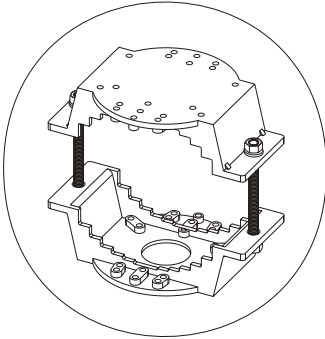

[INSTALLING PLATE AT THE POLE]

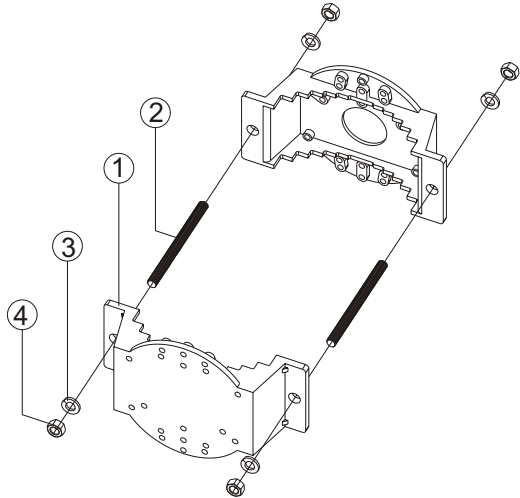
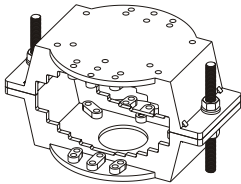

[POLE MOUNT ASS'Y - EXPLODED VIEW]

➤ PART LIST

NO	PART NAME	Q'TY	DESCRIPTION
1	POLE MOUNT PLATE	2	Aluminum, light gray polyester powder coat
2	BOLT	2	M8x100L
3	HEX NUT	4	M8 type
4	SPRING WASHER	4	M8 type
5	MACHINE SCREW	4	PH M6x14L
6	MACHINE SCREW	8	PH M6X20L