

# CSW778CW/CSB778CW

## Light Duty, Wall Mount for 23"~32" LCD monitor

### PRODUCT FEATURES

- . Light duty wall mount
- . Steel and aluminum
- . Maximum load 55 lbs (25 kg)

The arm mount is light duty wall mount designed for use with LCD monitor.

This mount is for use in wall mounting applications and is capable of supporting loads up to 55 lbs (25 kg).

- The arm mount must be attached to a structural object, such as a hard wood, wall stud that supports the weight of the mount.
- Use the set screw to tighten the pipe.

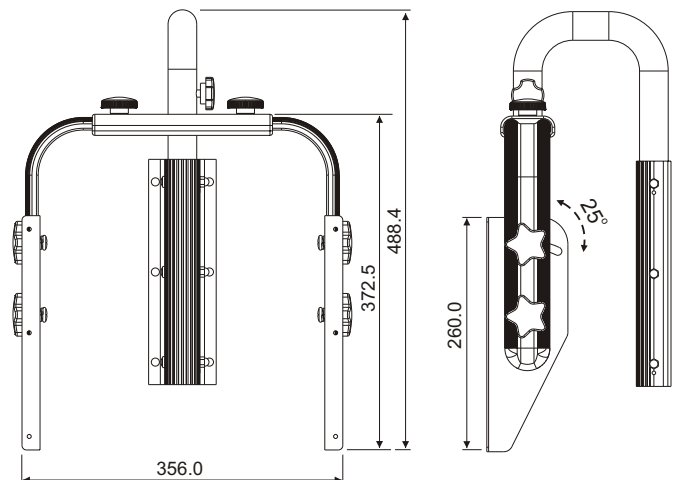
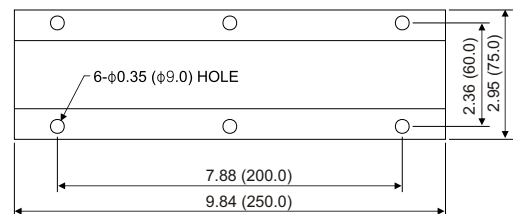
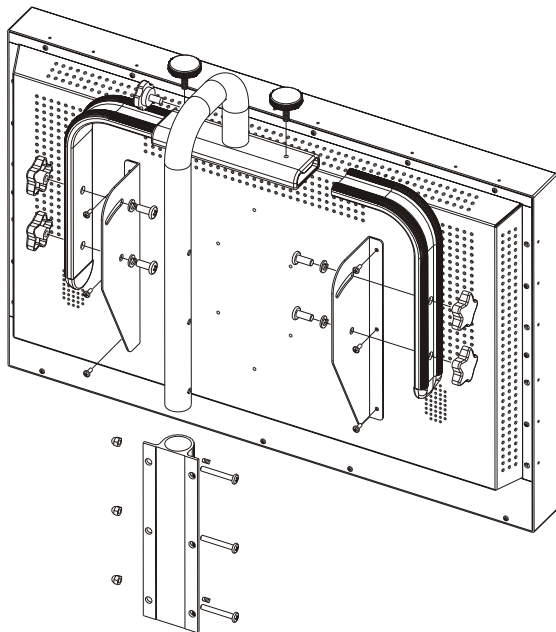
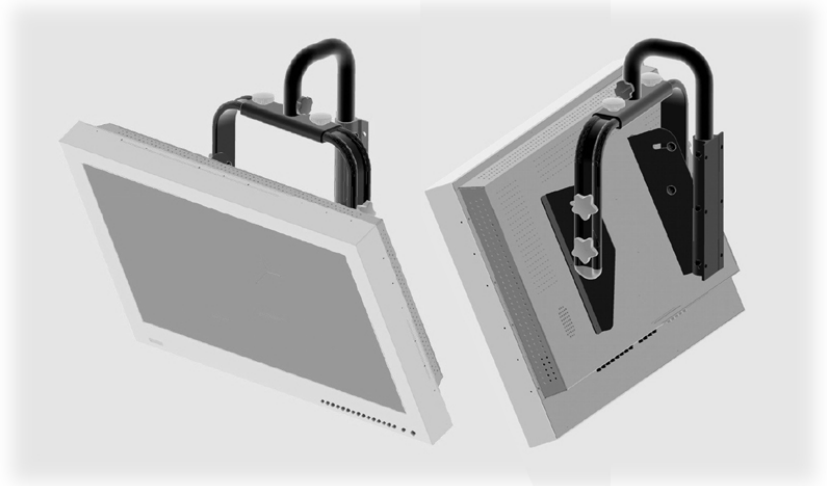

Unit: mm

# Light Duty, Ceiling Mount for 23"~32" LCD monitor

## PRODUCT FEATURES

- . Light duty ceiling mount
- . Steel and aluminum
- . Cable feed through hole conceals wiring
- . Maximum load 55 lbs (25 kg)
- . Pipe adaptor (NPS 1 1/4")

The arm mount is light duty ceiling mount designed for use with LCD monitor.

This mount is for use in ceiling mounting applications and is capable of supporting loads up to 55 lbs (25 kg).

- The arm mount must be attached to a structural object, such as a hard wood, wall stud or ceiling rafter, that supports the weight of the mount.



- Attach the mount to pipe (NPT 1 1/4")(Not supplied) using the ceiling arm mount units.  
(Note: Standard pipes are available at your local hardware store.)

- Use the set screw to tighten the pipe.

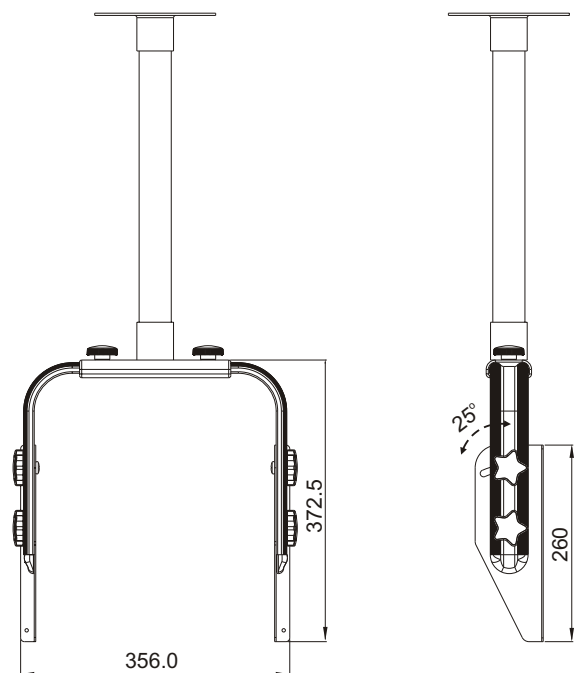
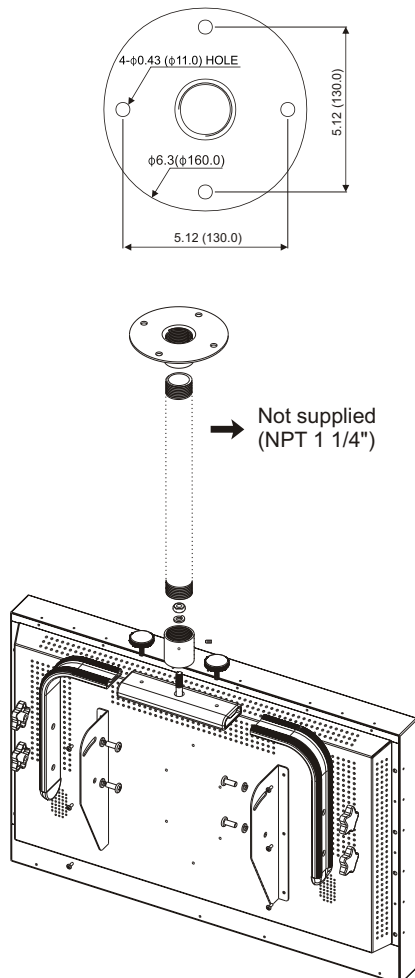

Unit: mm

Printed in Korea

# CSW778CW/CSB778CW

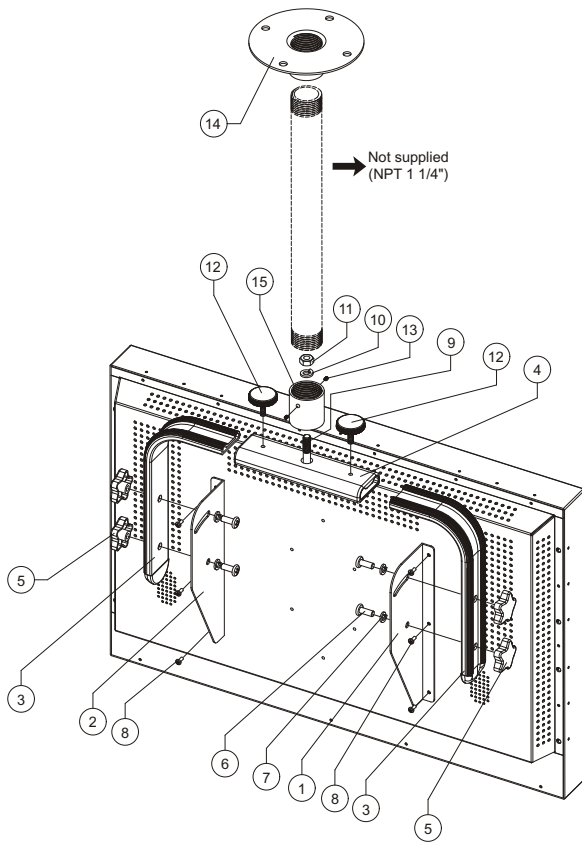

Figure 1. Ceiling Mount kit.

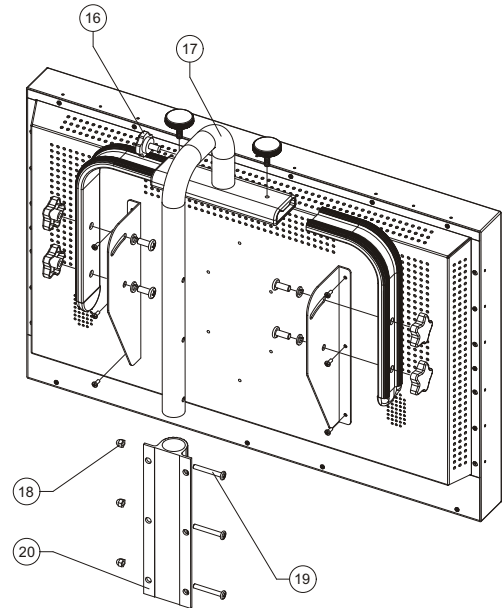

Figure 2. Wall Mount kit.

## Items included (Quantity)

- [1] Base Bracket L, EGI 2.0t(1)
- [2] Base Bracket R, EGI 2.0t(1)
- [3] Side Bar, Al(2)
- [4] Cross Bar, Al(1)
- [5] Handle Nut\_M8, ABS(4)
- [6] Screw Machine\_M8x20L, SUS(4)
- [7] Washer Spring\_M8 type, SUS(4)
- [8] Screw Machine\_M4x10L, SUS(6)
- [9] Wrench Bolt\_M12x50L, SUS(1)
- [10] Washer Spring\_M12 type, SUS(1)
- [11] Hex Nut\_M12 type, SUS(1)

- [12] Handle Bolt\_M6x15L(2)
- [13] Set Screw\_M5x5L, SUS(4) - ceiling mount only
- [14] Ceiling m/t Base, NPS 1 1/4" (1) - ceiling mount only
- [15] Pipe Socket, NPS 1 1/4"(1) - ceiling mount only
- [16] Handle Bolt\_M8x15L(1) - wall mount only
- [17] Wall m/t Pipe, Al(1) - wall mount only
- [18] Cap Nut\_M6(3) - wall mount only
- [19] Screw machine\_M6x45L(3) - wall mount only
- [20] Wall m/t Bracket, Al(1) - wall mount only
- [21] L-wrench\_2.5mm(1) - not described